



CATHEDRAL ROAD

PONTCANNA





CATHEDRAL ROAD

PONTCANNA, CF11 9PH - £995 PCM



1 bedroom(s)



1 bathroom(s)



485.00 sq ft

Jeffrey Ross are pleased to market this spacious ground floor one bedroom apartment, in this refurbished Victorian property situated in the sought after area of Pontcanna. The property comprises of bay fronted open plan lounge/fully fitted kitchen with integrated appliances, full bathroom suite with shower and double bedroom. Available furnished and further benefits from off-road parking.

Video Tour Available (February 2021): <https://youtu.be/HmUsTUcfutA>

Council Tax Band: D

EPC Rating: C

A holding fee of one weeks' rent will be payable to secure the dwelling. This will be deducted from the final balance payable upon moving into the dwelling, subject to a successful application. Jeffrey Ross Limited reserves the right to retain this payment should the applicant have provided false or misleading information at the time of applying for the dwelling or failed to take reasonable steps to enter into the Standard Occupation Contract.

PROPERTY SPECIALIST

Ms Cody Byrne

cody@jeffreypass.co.uk

Property Management Co-ordinator





Energy Efficiency Rating

	Current	Potential
Very energy efficient - lower running costs		
(92 plus) A		
(81-91) B		
(69-80) C	77	77
(55-68) D		
(39-54) E		
(21-38) F		
(1-20) G		
Not energy efficient - higher running costs		
England & Wales	EU Directive 2002/91/EC 	





”

Comments by Ms Cody Byrne

”

Cathedral Road, Pontcanna

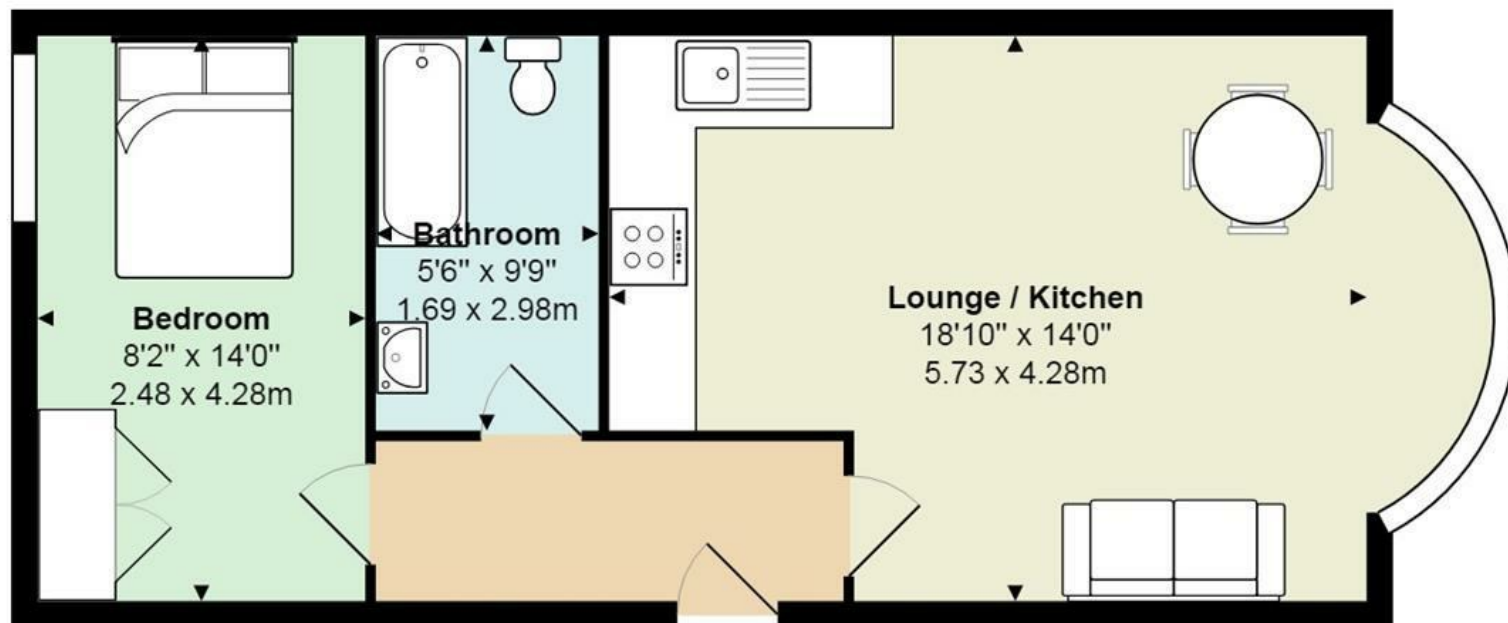

Total Area: 485 ft² ... 45.0 m²

All measurements are approximate and for display purposes only

www.jeffreyross.co.uk

Jeffrey Ross